

Client _____ Quantity _____
 Project _____ Position _____

FUN 600

Model: F60/30PCG/T

Cod: MP01012011000



Technical data

Modularity:	Top
Dimension (mm):	300x600x300
Total gas power (Kcal/h):	5933
Total gas power (kW):	6,9
Gas connection:	1/2"
Net volume (m3):	0,054
Packing dimensions (mm):	376x695x596
Gross weight (kg):	15
Burner power 1 (kW):	3,6
Burner power 2 (kW):	3,3
Gross volume (m3):	0,156

Features

Burners:	Piezo ignition available in double or single crown
Grill:	Removable enamelled container for cleaning
Working top:	Made of AISI 304 stainless steel with a thickness of 8/10 mm
Knobs:	Knobs are made from a sturdy heat-resistant polymer blend
Flue:	Made in a single piece, which facilitates the alignment of the modules
Kit Gas:	Natural gas conversion kit 30/50 m/bar (tested with natural gas G20)

Technical draw

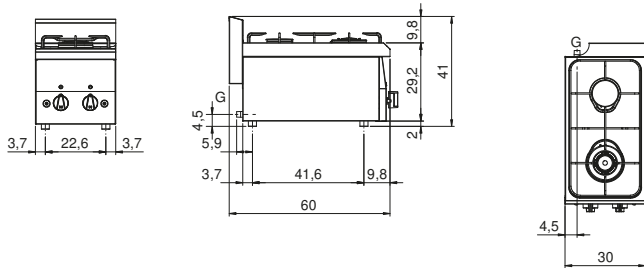

G: Gas connection 1/2"